

SETTING UP SYSTEM

Prior to setting up GF system, make sure all the stations have been installed and wired in proper manner. Leave the front frame & module panels unattached.

Step 1 Press PROGRAM switch on GF-DA Speech Module.

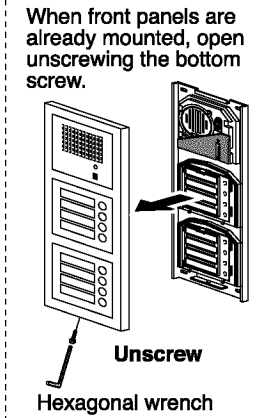
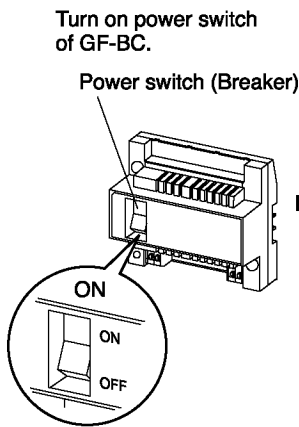

Open the rubber cap. Then push PROGRAM SW. momentarily.

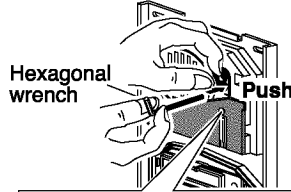

In-use LED

Wait for approx. 15 sec. and see the LED steadily lit.

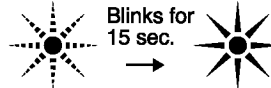

Note: At the rest Entrance stations, the in-use LED is steadily lit and blocks out any calling.

SETTING FOR "LIGHT" button (OPTION)

In-use LED



While In-use blinks (within 15 sec.), press an assigned call button.

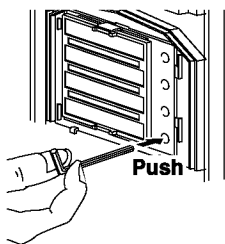

BEEP tone
→ **LIGHT button is set.**
(Turns on entrance light, controlled by MAW-B relay.)

Step 2 At an Apartment station #1, lift handset. Communication channel is established with Entrance station instantly. Hearing single BEEP tone means the station correctly set. Hang up handset.

Apartment station #1

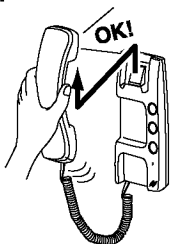

Entrance station

BEEP TONE

→ Call button 1 - Apartment 1 is set.

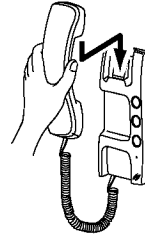
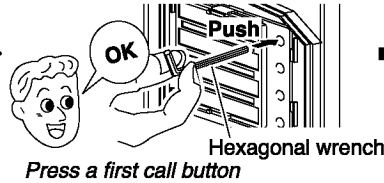

For a second station, if installed, lift second handset and press the same call button 1. Beep tone sounds twice.

Second Apartment station #1

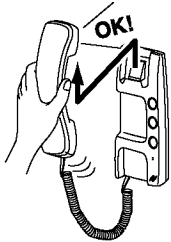

Entrance station

DOUBLE BEEP TONE

→ Call button 1 - Apartment 1 - 2 is set.

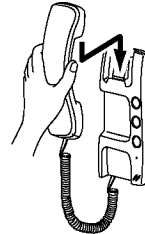
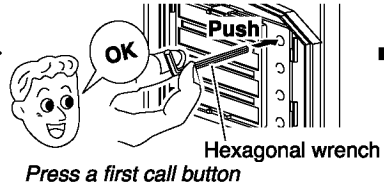

Step 3 Go to each apartment consecutively, and program each handset station in the same manner as in Step 2.

Step 4 When completed, press PROGRAM switch on GF-DA Speech Module again to finish the programming.

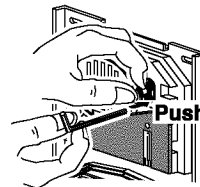

Do not forget to replace the rubber cap.

To correct wrong setting

Apartment station
Lift handset.

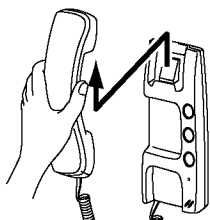

Entrance station

Keep pressing a call button to clear until a continuous tone is heard.
(Consecutively, operate same way for next call button, if any)

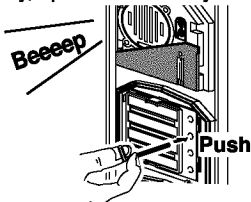

Following Step 2,
Reset on apartment station(s) that have been cleared.

For 2-station apartment

- Clearing a call button cancels programming for two stations, correctly set or not. Individually reprogram both stations.